



Welcome to the Residency Training Program in Otolaryngology–Head and Neck Surgery at New York Presbyterian Hospital – Columbia and Cornell campuses. We are glad you are here to see the outstanding opportunities offered by our training program. This is a unique program, which combines the resources of Departments of Otolaryngology-Head and Neck Surgery at two Ivy League medical schools, and includes rotations at three top-ranked hospital campuses.

We are fortunate to have already an outstanding group of residents, and we look forward to meeting you.

Sincerely,

Lanny Garth Close, MD

Howard W. Smith Professor and Chairman
Department of Otolaryngology-Head & Neck Surgery
Columbia College of Physicians and Surgeons
Co-Residency Program Director

Michael G. Stewart, MD, MPH

Professor and Chairman
Department of Otorhinolaryngology
Weill Cornell Medical College
Co-Residency Program Director

New York-Presbyterian Hospital

The New York-Presbyterian Hospital, a nationally ranked medical institution, was officially established as a single hospital complex in 1997 through the merger of two renowned medical centers: the former Columbia-Presbyterian Medical Center, and New York Hospital. The merged hospital has two main campuses: New York-Presbyterian Hospital/Columbia University Medical Center in the Washington Heights section of upper Manhattan, and New York-Presbyterian Hospital/Weill Cornell Medical Center on the upper east side of Manhattan. Memorial Sloan Kettering, the third hospital involved in the Otolaryngology residency, is located across York Avenue from Weill Cornell Medical Center.

New York-Presbyterian Hospital is ranked #6 in the USA in the US News and World Report rankings, and is one of only 4 hospitals in the country to be ranked in 16 of 16 specialties. Memorial Sloan Kettering is currently ranked #2 among cancer centers in the USA.

Otolaryngology/Head and Neck Surgery Training Program

Specialties/Divisions:

General Otolaryngology and Basic Science Education

The General Otolaryngology experience is very strong at both Columbia and Weill Cornell sites. Residents experience the full gamut of specialties and are well trained to become exceptional general otolaryngologists after residency. Each site has full-time faculty with general otolaryngology practices, whereas at many training programs, every faculty member is a sub-specialist. In addition to clinical experience, there is a formal didactic curriculum, including a yearly anatomy course with head and neck cadaver dissection, and temporal bone dissection course. Throughout the year, a series of basic and clinical science lectures are given to the residents. These lectures are organized over a two year curriculum, so that each resident repeats the basic science and clinical lecture series twice throughout their residency. Topic content is based on the Scope of Knowledge report from the American Board of Otolaryngology to prepare residents for In-training and Board examinations. In addition, as part of that schedule, residents supplement their knowledge by using the COCLIA curriculum in weekly small group discussions led by a faculty member during protected academic time.

There are also several other weekly academic activities which add to the learning environment including: weekly multidisciplinary Radiology rounds, weekly tumor boards, morning rounds with various attendings, monthly journal club, weekly landmark article discussions, weekly Departmental Grand Rounds, and more.

Hospital-based outpatient clinics at both Weill Cornell and Columbia are important aspects of the general otolaryngology experience and provide great learning experiences. The clinic attendings routinely have after-clinic lectures based on interesting case presentations seen during clinic/office hours. Research activities include various clinical reviews and prospective studies, outcomes research and quality of life studies, as well as many other opportunities.

Head and Neck Surgery

The head and neck surgical experience is extensive at all sites. Throughout the residency, residents participate in a variety of head and neck surgeries. Weekly radiology rounds with all of the attendings help to extend the experience beyond the operating room. Tumor boards occur weekly with a lively interdisciplinary discussion including otolaryngology, radiation oncology, medical oncology, pathology, as well as others depending on the cases. This ensures a full experience with the gamut of head and neck cancers. During the PGY-3 and PGY-5 years, every resident will spend 3 months at Memorial Sloan Kettering Cancer Center with the 8 full-time faculty members; the site director for the residency program is Dr. Dennis Kraus. These 6 months provide an intensive hands-on resident experience in diagnosis, evaluation, surgical, post-surgical, and non-surgical management of head and neck cancer. Research activities in head and neck include studies on pathology, surgical techniques in cancer treatment, Fanconi's anemia as a

model for head and neck cancer, development of a rat model for study of genetic determinants of various carcinomas, identification of tumor suppressor genes, and several other projects.

Rhinology and Endoscopic Sinus Surgery

Throughout residency, residents work with various attending otolaryngologists in the operating room, where we have state-of-the-art technology in video, photography, and surgical navigation CT scanning (Landmarx, VTI, Brainlab). The rhinology experience is extensive and all residents are very well trained by the end of their residency. There is also opportunity to be involved with endoscopic anterior skull base cases in conjunction with neurosurgery to expand the basic endoscopic sinus surgery skills. Research is ongoing in study of ciliary function in neonates, study of novel techniques for treatment of epistaxis, genetic analysis of patients with chronic sinusitis, novel approaches to endoscopic skull base surgery, outcome after computer-assisted endoscopic sinus surgery, effect of sinus surgery on voice parameters, role of local factors in pathogenesis of chronic rhinitis and sinusitis, and clinical research on obstructive sleep apnea and snoring.

Otology/Neurotology

Basic training occurs during the yearly anatomy course and the annual temporal bone courses with otology attendings. In addition, radiologic review of temporal bone anatomy is done weekly at radiology conference. Operative experience spans the entire spectrum of otologic and neurotologic surgery, including transnasal, anterior and lateral skull base surgery, in conjunction with neurosurgery.

Research in otology includes treatment modalities include treatment for sudden sensorineural hearing loss, implantable devices for hearing restoration, rehabilitative impact of cochlear implantation, performance of users of Bone-Anchored Cochlear Stimulators, inner ear perfusion for treatment of vertigo, hearing loss, tinnitus, treatment modalities for vertigo and sensorineural hearing loss, and pressure measurements of the inner ear. The Fowler Memorial laboratory at Columbia specializes in basic otologic research, including pressure phenomena in the middle and inner ear.

Pediatric Otolaryngology

Residents work with attendings in pediatric otolaryngology at both Children's Hospital of New York and Weill Cornell Medical Center. Residents begin in the operating room mastering general pediatric otolaryngology procedures and working closely with the attendings on various pediatric consults. Weekly teaching conferences are held with a specific focus on pediatric otolaryngology. Multidisciplinary craniofacial clinics are held monthly and include otolaryngology, plastic surgery, OMFS, pediatrics, genetics, neurology and speech pathology in a joint setting. As residents gain experience, they participate in more complex cases including airway reconstruction, sinus surgery, otology, and head and neck cases. Also, there are potential opportunities for surgical mission trips for cleft palate surgery in Central America and Asia. Pediatric otolaryngologic research activities include pathology and treatment modalities for otitis media, treatment of cystic fibrosis, hearing impairment in children, and treatment of velopharyngeal insufficiency and its voice ramifications.

Laryngology/Voice Disorders

The laryngology experience is extensive at both Columbia and Weill Cornell campuses, including anatomy, physiology, and pathology. Specific techniques for laryngology include Flexible Endoscopic Evaluation of Swallowing with Sensory Testing (FEESST), flexible laryngoscopy, videostroboscopy, transnasal esophagoscopy, in-office laryngeal biopsy, in-office laryngeal injections, as well as many others. In office and operative techniques are progressively mastered during residency. The laryngologists work closely with speech pathologists in voice retraining and voice therapy. Dr. Sulica and Dr. Aviv frequently will have impromptu teaching sessions as interesting patients present. Research activities include 3D imaging reconstruction of the larynx, aerodynamic studies of the glottis in teenagers, swallowing disorders, evaluation using FEESST, optical transesophageal echocardiography, transnasal esophagoscopy, outcomes in treatment of voice disorders, care of the professional voice, laryngeal physiology, and voice acoustics and aerodynamics.

Facial Plastic and Reconstructive Surgery

Facial plastics activities are present at both Columbia, Weill Cornell, and their satellite surgical office suites. There is opportunity to get involved with the full-time facial plastic surgeons at both locations, and also work with the voluntary faculty, in cosmetic and reconstructive facial plastic surgery. There is a quarterly plastics teaching course for the residents to gain further exposure to some of the basics in facial analysis, planning, and cases studies. In addition, a weekly session of one hospital-based clinic is dedicated to facial plastics, which provides some clinic-based cases for residents. Research activities include mechanisms of facial nerve regeneration, tissue growth factors, factors affecting nasal obstruction, as well as others.

Allergy

Allergy is a growing field at both Columbia and Weill Cornell, with full allergy programs including testing and treatment in place at both campuses. Residents work with the otolaryngic allergy specialists at both locations to learn the background to allergy testing and immunotherapy. Patients in the hospital-based clinic who are believed to have an allergic component to their disease are encouraged to bring them for further testing and immunotherapy treatment, which is performed by the resident under supervision. This level of involvement during training will enable residents to qualify for the otolaryngic allergy boards, if desired.

Audiology

Audiology is a part of the Department at both Columbia and Weill Cornell campuses, where audiograms, electronystagmograms, auditory brainstem response testing, and other audiologic tests are performed, as well as prescribing and dispensing hearing aids and other rehabilitative devices. Both hospital sites have programs in newborn hearing screening for early identification of hearing loss. Doctoral-level audiology faculty members are also integral parts of the resident's didactic curriculum.

Research initiatives include rehabilitative impact and outcome measures, cochlear implants, efficacy of new technology, development of new test procedures and materials, challenges in geriatric aural rehabilitation, central auditory disorders and evaluation methods, early detection of hearing loss, effect of micronutrient deficiencies on hearing in developing countries, and outcomes of neonatal hearing screening failures.

Residency Program:

The department accepts 4 residents per year, after a recent approval for an expansion by the ACGME.

The first year is spent on rotations in the Departments of Surgery at Columbia and Weill Cornell that help prepare residents for training in Otolaryngology-Head and Neck Surgery. 1-2 months of internship are spent on Otolaryngology-Head and Neck Surgery. Other rotations include but not limited to: general surgery, emergency medicine, vascular surgery, plastics, anesthesia, and neurological surgery.

The subsequent 4 years are spent on the Otolaryngology-Head and Neck Surgery service at the various sites. For residents starting in 2008, during the PGY-1 year you will spend 6 months at Columbia and 6 months at Weill Cornell. During years PGY-3 through -5, you will spend 18 months at Columbia, 18 months at Weill Cornell, 6 months at Memorial Sloan-Kettering, 3 months on research, and 3 months at St. Luke's-Roosevelt Medical Center. Both Weill Cornell and Columbia have the full complement of subspecialties of Otolaryngology/ Head and Neck Surgery, giving a wide basis of experience for residency training. Memorial Sloan-Kettering has a primary focus on head and neck oncology and provides an oncology experience that is among the best in the nation.

Current Residents, their hometown, and their medical school:

PGY5

From: Paul Johnson
Wyoming
Med School: U of Washington



Vicki Owczarzak
Pittsburgh, PA
Drexel



Jeffrey Liu
Taiwan/US
Weill Cornell



PGY4

From: Tali Lando
New Jersey
Med School: Weill Cornell



Scott Rickert
Netherlands/US
Columbia



Caroline Yoon
Texas/Seattle
Baylor



PGY3

From: Joshua Levinger
New York
Med School: Weill Cornell



David Rosow
Boston, MA
Harvard



Kathy Yu
California
UCLA



PGY2

From: Amy Hsu
New York
Med School: Columbia



Deya Jourdy
New York
Weill Cornell



Dara Liotta
New York
Columbia



PGY1

From: Alyn Kim
Korea/USA
Med School: David Geffen
SOM at UCLA



Alison Maresh
Hartford, CT
Yale



Saral Mehra
Canada
Columbia



From: Roheen
Raithatha
Lexington, KY
Med School: Tufts





Full-time Faculty:

Lanny Garth Close, MD: Professor and Chairman of Otolaryngology-Head and Neck Surgery at Columbia University Medical Center
Specialties: Head and Neck Oncology, Voice and Swallowing disorders, Endoscopic Sinus Surgery, Skull Base Surgery

Jeffrey Ahn, MD: sinus surgery, facial plastics

Jonathan Aviv, MD: laryngology/swallowing and voice disorders

Salvatore M. Caruana, MD: head and neck surgery oncology, microsurgery for head and neck tumors, thyroid and parathyroid surgery

Sezelle Gereau-Haddon, MD: pediatric otolaryngology

Soha N. Ghossaini, MD: general otolaryngology, otology

Eli Grunstein, MD: pediatric otolaryngology

Joseph Haddad Jr., MD: Vice-Chair of Otolaryngology-Head and Neck Surgery, Chief of Pediatric Otolaryngology

Shyam M. Khanna, Ph.D. (*special lecturer*): otology research

Thomas Murry, Ph.D: laryngology/swallowing and voice disorders

Elizabeth Olson, Ph.D: biophysics/otology research

Hector Rodriguez, MD: general otolaryngology, sinus surgery, allergy testing and treatment

Jaclyn Spitzer, Ph.D: audiology, audiology research

Ian S. Storper, MD: neurotology/otology

Gloria Su, Ph.D: head and neck cancer research

Monica Tadros, MD: facial plastics



York Avenue Ambulatory Care Center

Full-time faculty:

Michael Stewart, MD, MPH: Chairman and Otorhinolaryngologist-in-Chief, Professor of Otorhinolaryngology and Public Health
Specialties: general otorhinolaryngology, head and neck trauma

Max April, MD: pediatric otolaryngology

Ashutosh Kacker, MD: rhinology/sinus surgery, general otorhinolaryngology, skull base surgery

William Kuhel, MD: head and neck surgery, thyroid/parathyroid

David Kutler, MD: head and neck surgery, general otorhinolaryngology

Anthony LaBruna, MD: facial plastics, general plastic surgery

Jerry Lin, MD: general otolaryngology

Joseph Montano, EdD: audiology, audiology research

Mukesh Prasad, MD: general otorhinolaryngology, rhinology/sinus surgery

William Reisacher, MD: general otorhinolaryngology, allergy and allergic disorders

Rita Roure, MD: general otorhinolaryngology

W. Shain Schley, MD: general otorhinolaryngology

Samuel Selesnick, MD: Vice-Chair of Department of Otorhinolaryngology;

Specialties: otology/neurotology, skull base surgery

Lucian Sulica, MD: laryngology, voice disorders

Erich Voigt, MD: general otolaryngology

Robert Ward, MD: Chief of pediatric otolaryngology



Memorial Sloan-Kettering
Cancer Center
The Best Cancer Care. Anywhere.



Full-time faculty:

Jatin P. Shah, MD: Chief, Head and Neck Service; Elliot W. Strong Chair in Head and Neck Oncology

Jay O. Boyle, MD: head and neck surgery

Ryan Branski PhD: laryngology/voice disorders research

Dennis H. Kraus, MD: head and neck surgery, speech rehabilitation

Snehal Patel, MD: head and neck surgery

Ashok Shaha, MD: head and neck surgery

Bhuvanesh Singh, MD: head and neck surgery, director of epithelial cancer biology

Richard Wong, MD: head and neck surgery

Columbia and Weill Cornell voluntary faculty:

There are many voluntary faculty that practice at both institutions, and the residents interact with these faculty as well.

Weill Cornell:

Vijay Anand MD: sinus surgery, skull base surgery
Linda Dahl MD: general otorhinolaryngology
Lloyd Dropkin MD: general otorhinolaryngology
David Edelstein MD: general otorhinolaryngology
Robert Guida MD: facial plastic surgery
Clark Huang MD: general otorhinolaryngology, sinus surgery, skull base surgery
Jerry Huo MD: general otorhinolaryngology
Milton Ingerman MD: general otorhinolaryngology
Jacqueline Jones MD: pediatric otorhinolaryngology
Alvin Katz MD: general otorhinolaryngology
Inocencio Kho MD: general otorhinolaryngology
Charles Kimmelman MD: general otorhinolaryngology, rhinology
Samuel Nodelman MD: general otorhinolaryngology
Ariadna Papageorge MD: general otorhinolaryngology
Norman Pastorek MD: facial plastics
Larry Shemen, MD: general otorhinolaryngology, head and neck surgery
Raymond Soletic MD: general otorhinolaryngology
Sarah Stackpole MD: general otorhinolaryngology
Lisa Szubin MD: general otorhinolaryngology

Columbia:

Andrew Blitzer, MD: laryngology, voice and swallowing disorders
Eric Cohen, MD: general otolaryngology
Youngnan Jenny Cho, MD: general otolaryngology
Peter D. Costantino, MD: skull base surgery, otology/neurotology, facial plastics
Lee D. Eisenberg, M.D: general otolaryngology
Mark Fox, MD: general otolaryngology, head and neck surgery
Philip Ho, MD: general otolaryngology
Corinne Horn, MD: facial plastics
Ofer Jacobowitz, MD: general otolaryngology
Albert Jen, MD: general otolaryngology, facial plastics
Michael E. Jones, MD: general otolaryngology
Maurice M. Khosh, MD: facial plastics
Daniel Kuriloff, MD: general otolaryngology
Arlene Markowitz, MD: general otolaryngology
Orville Palmer, MD: general otolaryngology, head and neck surgery
Robert Parks, MD: general otolaryngology, head and neck surgery
Daniel Pender, MD: general otolaryngology
Steven Pearlman, MD: facial plastics
Geoffrey Pollack, MD: general otolaryngology
Ran Rubinstein, MD: general otolaryngology
Howard Smith, MD: general otolaryngology, facial plastics, head and neck surgery
Jayde Steckowych, MD: general otolaryngology

Housing:

New York-Presbyterian owns and leases approximately 1,600 residential apartments located adjacent and in close proximity to the East Campus on the Upper East Side of Manhattan (primarily a residential neighborhood). Our buildings are within walking distance of Central Park and the East River Promenade, and to all types of stores and restaurants in the neighborhood. We are also convenient to mass transportation (the Lexington Ave. subway line, uptown, downtown and crosstown buses).

Helmsley Medical Tower - 1320 York Ave.



1 Bedroom



Studio Apt.



Payson House - 435 E. 70th Street 1 Bedroom

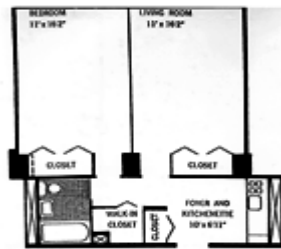

3 Bedroom Apt.



Phipps House - 445 E. 68th Street 1 Bedroom

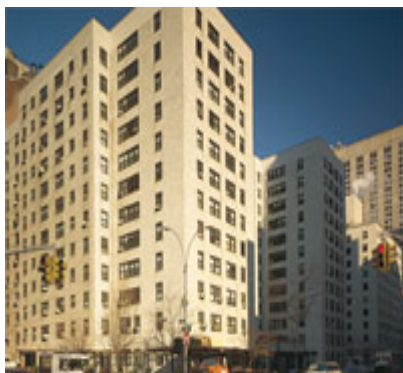

2 Bedroom



Each Campus offers on-site daily parking accommodations for patients and visitors and **monthly parking accommodations** (limited availability) for staff.



New York City: Myths

New York City is a vibrant collection of melding neighborhoods and boroughs. Above all, it is a walking city. Both Columbia and Weill Cornell are located in Manhattan - the epicenter of New York City - and are within easy walking distance to all forms of public transportation (subway, bus, train). There are many misconceptions about New York and living here.

1. *"You have to be rich to live in New York"*
Actually there are many daily events that are free or close to free. There is even a weekly magazine (Time Out New York) that routinely lists all the hundreds of daily events, many of which are free. Residents can select housing in a desirable section of Manhattan, at significantly subsidized rental rates – and without having to go through a realtor.
2. *"You have to be from New York to live in New York"*
New York is the quintessential melting pot. Besides its tremendous ethnic diversity, many people from other states and countries move to New York to be a part of it. Of the residents, 60% are not from New York or the surrounding area. Of the attendings, 60% are not from New York, including both chairmen.
3. *"New York is an unsafe city"*
Crime in New York City is the lowest among the 25 largest cities in the United States. Since 1991, New York City has seen a continuous fifteen-year trend of decreasing crime. Neighborhoods that were once considered dangerous are now much safer. Violent crime in the city has dropped by 75% in the last twelve years and the murder rate in 2005 was at its lowest level since 1963. Overall, New York City had a rate of 2,801.6 crimes per 100,000 people in 2004, compared with 8,959.7 in Dallas; 7,903.7 in Detroit; 7,402.3 in Phoenix; 7,346.8 in San Antonio; 7,194.8 in Houston; 5,470.5 in Philadelphia; 4,376.0 in Los Angeles; and 4,102.7 in San Diego.
4. *"New York is hard to get from place to place"*
New York has one of the most developed and wide-reaching public transportation systems in the world. Between subways, buses and trains, it's rare to be more than a couple of blocks from public transportation. The subway and bus cost \$2 per ride (less with a monthly pass), and one transfer is free. Taxis provide the most direct service, are easily found throughout Manhattan, and fares are among the lowest in the USA. NYC is so compact that distances are not large.
5. *"New York is a rude city"*
Actually, this one isn't exactly a myth. While there are many friendly people here, unfortunately a lot of New Yorkers are rude. So deal with it. ☺